

1056-0026/0027

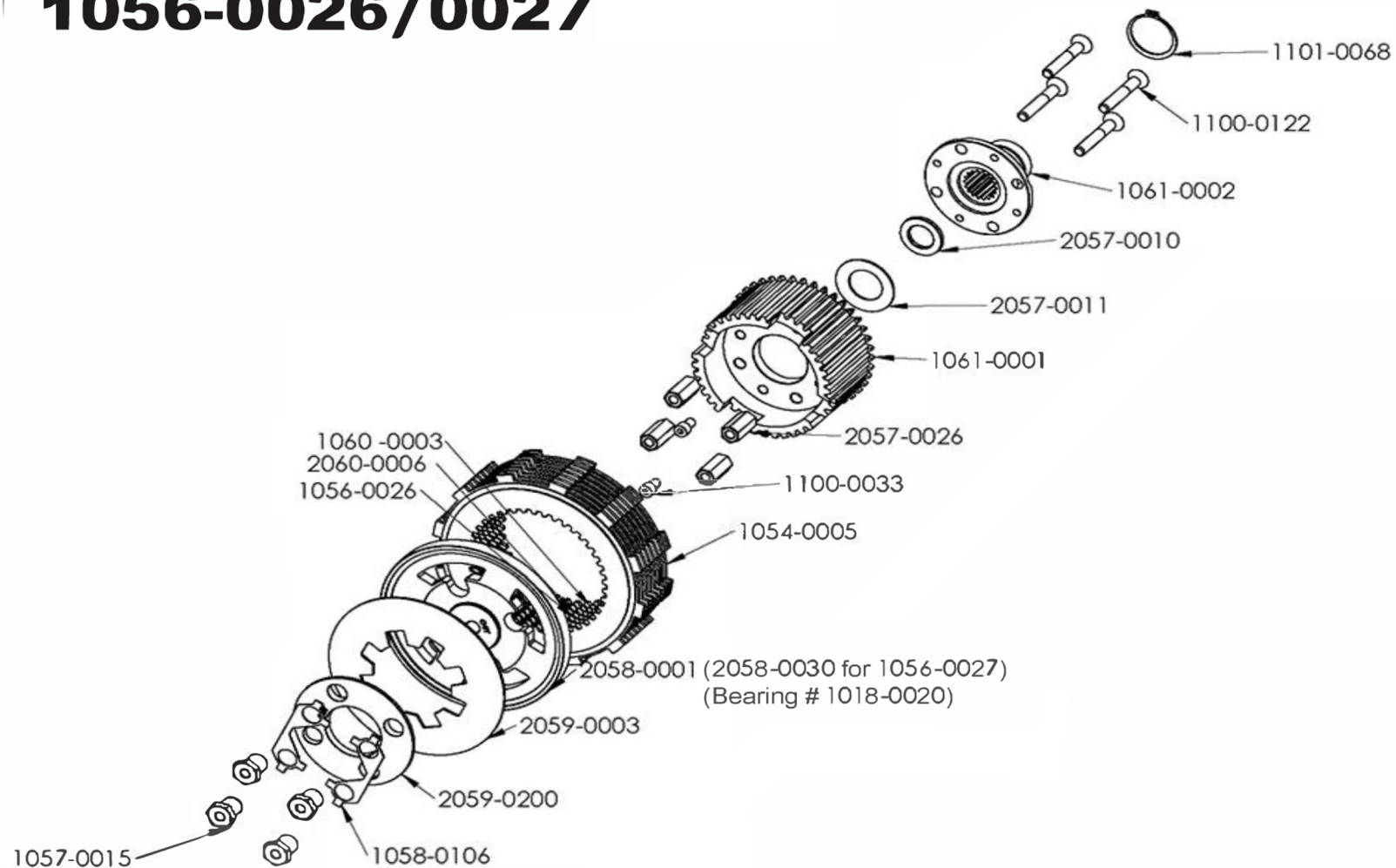

1056-0026/0027 Fits 2011 - 2017 Big Twin Except M8 Models

Qty	Part #	Description
1	1061-0002	Steel inner hub only
1	1061-0001	Outer hub (aluminum) only
1	2057-0010	Thrust washer
1	2057-0011	Bellview washer
2	1100-0033	Screws for clutch hub
4	1100-0122	Bolts for mounting alum. plate
4	2057-0026	Stand-off hub nuts
8	1054-0005	Clutch friction plate/Kevlar
5	2060-0007	Steel Clutch Plate 080"
3	2060-0006	Clutch plate steel (.047")
1	1060-0003	Clutch plate steel (.120")
1	1101-0068	Small snap ring
1	2058-0001	Pressure plate (2058-0030 for 1056-0027)
1	2059-0003	Diaphragm clutch spring (silver/medium)
1	2059-0200	Diaphragm spring retainer
4	1057-0015	Shouldered nuts (for retainer)
2	1058-0106	Lock clips for retainer nuts
1	2057-0024	Shims for clutch pack (4 large / 4 small)
1	1108-0006	Installation instructions